

# THE *Plaza* AT LAKEVIEW



31569 Canyon Estates Dr., Lake Elsinore, CA 92352

www.PlazaLakeview.com

First Floor

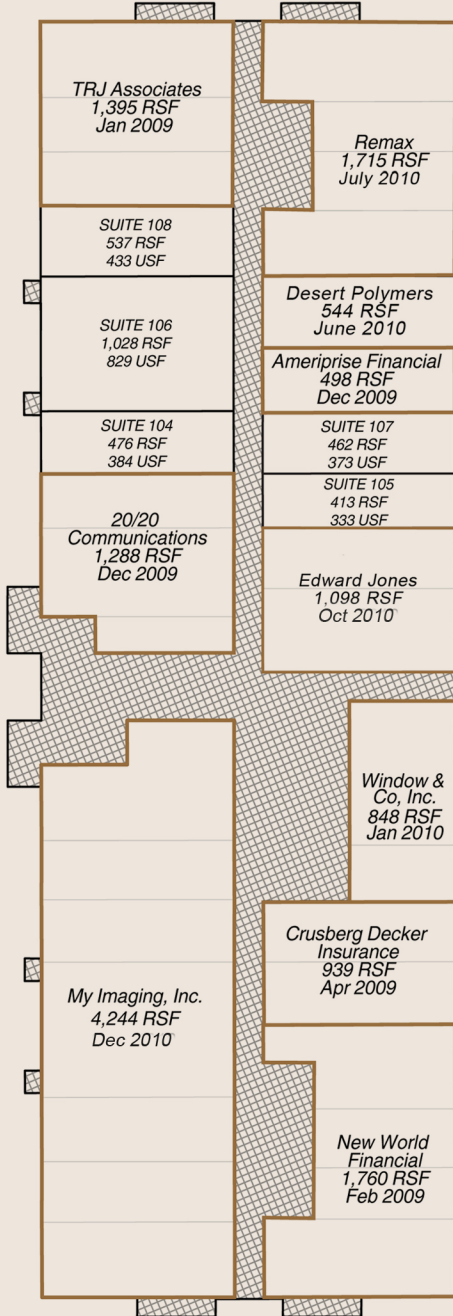

Second Floor

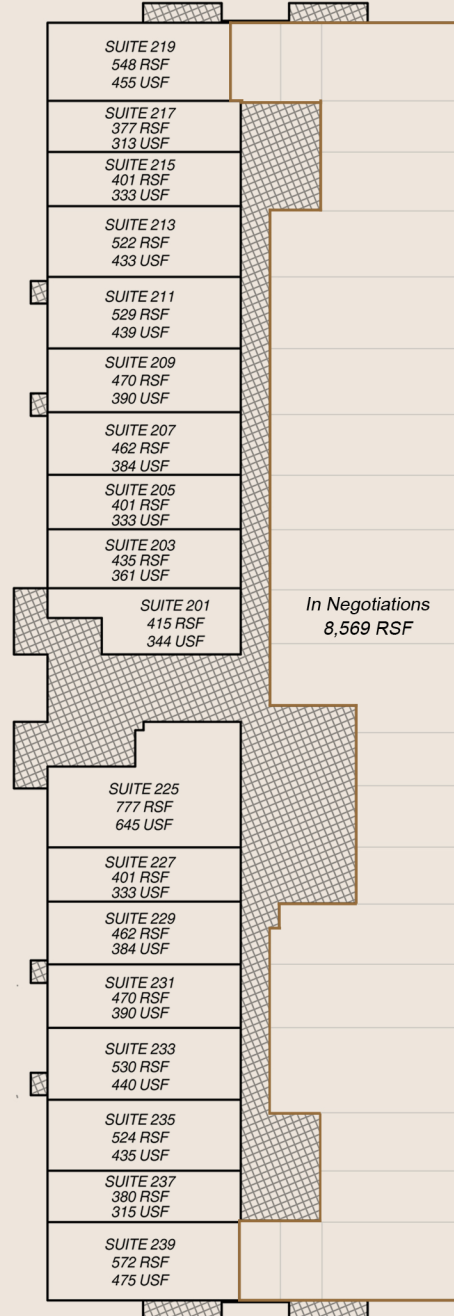

RSF = RENTABLE SQ FT  
USF = USABLE SQ FT



**KIP DUBBS**  
877-589-0670  
KDubbs@OmniWestGroup.com  
CA License No. 01870119

The information contained herein was obtained from third parties, and has not been independently verified by the real estate brokers. Buyers/tenants should have the experts of their choice inspect the property and verify all information. Real estate brokers are not qualified to act as or select experts with respect to legal, tax, environmental, building construction, soils-drainage or other such matters. Prices vary depending on location. Premium pricing and minimum size requirements apply to some units. All signage subject to further approvals. The Plaza at Lakeview was developed by the Lake Elsinore Medical Campus, LLC. \*100% structured financing is available and offered through Business Community Capital for qualified customers. 9/2010

# THE *Plaza* AT LAKEVIEW



31571 Canyon Estates Dr., Lake Elsinore, CA 92352

www.PlazaLakeview.com

First Floor

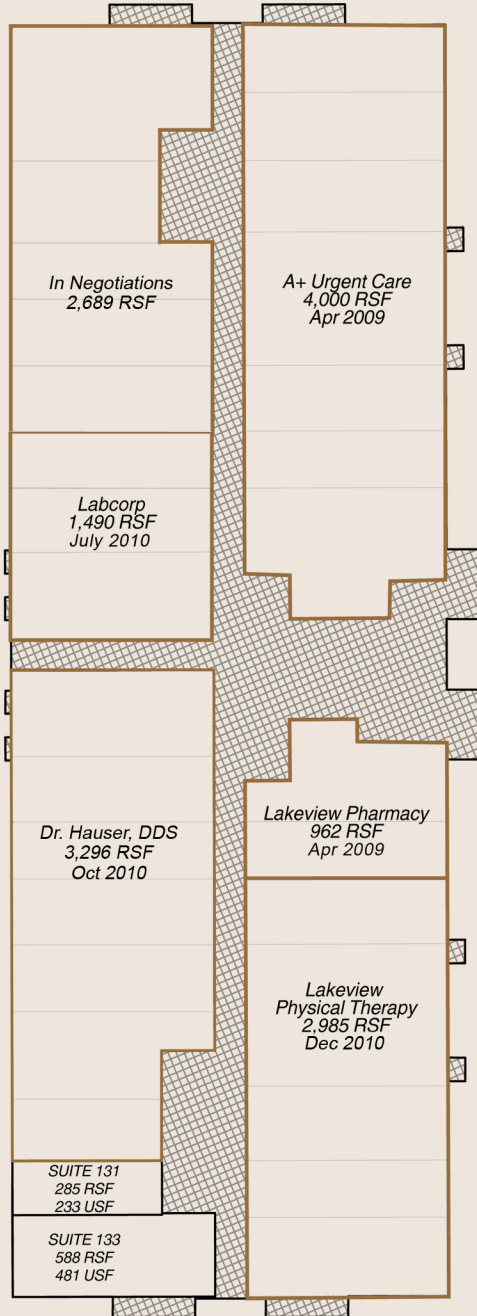

Second Floor

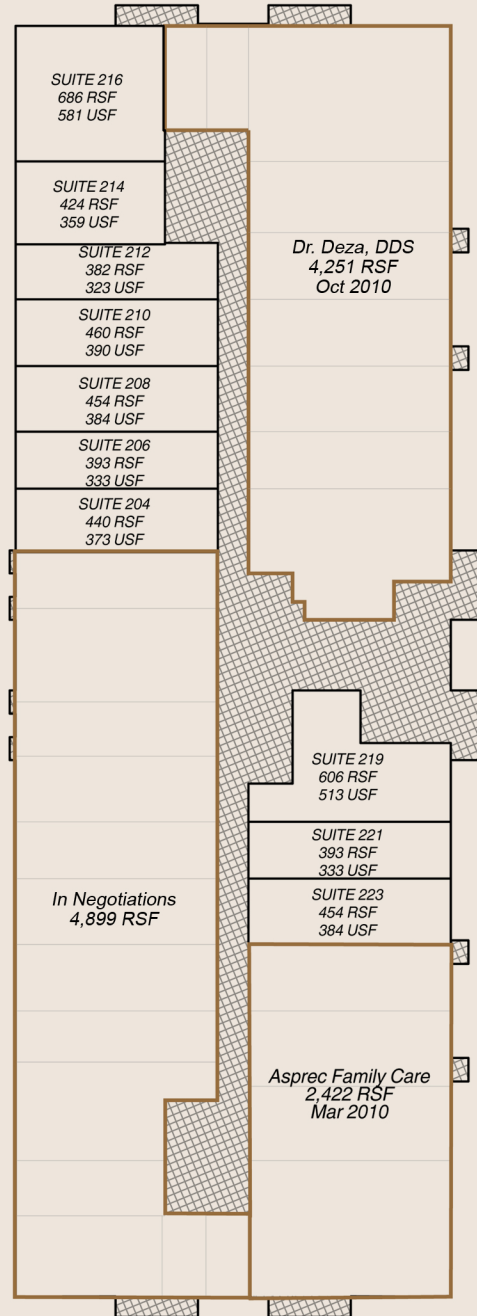

RSF = RENTABLE SQ  
USF = USABLE SQ FT



**KIP DUBBS**  
877-589-0670  
KDubbs@OmniWestGroup.com  
CA License No. 01870119

The information contained herein was obtained from third parties, and has not been independently verified by the real estate brokers. Buyers/tenants should have the experts of their choice inspect the property and verify all information. Real estate brokers are not qualified to act as or select experts with respect to legal, tax, environmental, building construction, soils-drainage or other such matters. Prices vary depending on location. Premium pricing and minimum size requirements apply to some units. All signage subject to further approvals. The Plaza at Lakeview was developed by the Lake Elsinore Medical Campus, LLC. \*100% structured financing is available and offered through Business Community Capital for qualified customers. 9/2010